

PHYSICAL SPECIFICATION

Nominal Voltage Nominal Capacity (10HR)		12V 100Ah
Dimension	Length	331±2mm □13.03 inches□
	Width	176±2mm (6.93 inches)
	Container Height	214±2mm (8.43 inches)
	Total Height	218±2mm (8.58 inches)
Weight		Approx. 29.8 Kg (65.68lbs)
Standard Terminal		Bolt-and-nut terminal Bolt Type: M6

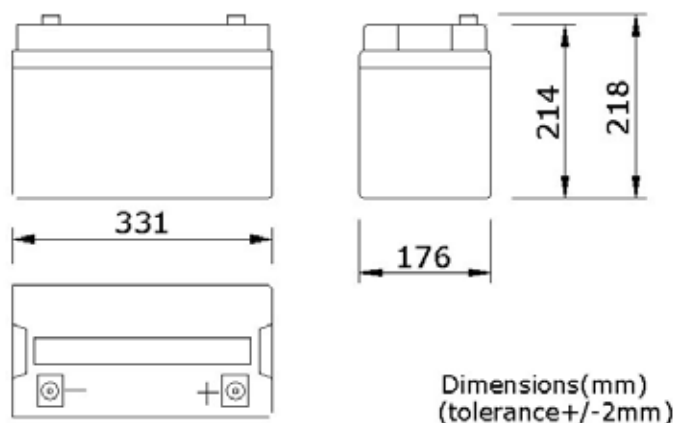

Dimensions(mm)
(tolerance+/-2mm)

Bolt-and-nut lead terminal
Bolt Type:M6

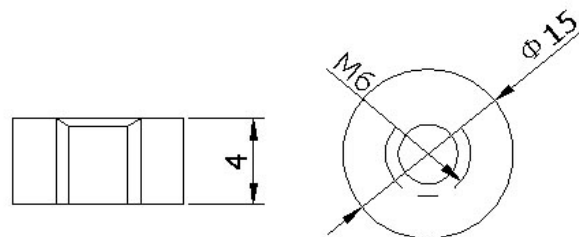

ELECTRICAL SPECIFICATION

Characteristics		
Capacity	10 hour rate (10A)	100Ah
	5 hour rate (17A)	85Ah
	3 hour rate (25A)	75 Ah
	1 hour rate (60A)	60Ah
Capacity affected by temperature	40□ □104 °F□	102%
	25□ □77 °F□	100%
	0□ □32 °F□	85%
Internal Resistance		Full charged battery (25□,77 °F) 4mΩ
Constant Voltage Charge	Cycle	Initial Charging Current less than 25A Voltage 14.1~14.4V at 25□ (77 °F) Temperature Coefficient -18mV/□
	Standby	No limit on Initial Charging Current Voltage 13.5~13.8V at 25□ (77 °F) Temperature Coefficient -18mV/□

Discharge curves @ 25 (77 °F)

